

## Hi-Q®/ERC Clamping Nuts for Internal Coolant for DS & KS disks (Hex & Spanner)

Type	Part No.	A [mm]	B [mm]	C	L1 [mm]	L2 [mm]	Drawing	Wrench
Hi-Q®/ERC 16	3416.20000	28	22.5	M22 x 1.50	12.0 – 15.5	5.0	1	7112.16010
Hi-Q®/ERC 20	3420.20000	34	24.0	M25 x 1.50	13.0 – 16.5	5.0	1	7112.20010
Hi-Q®/ERC 25	3425.20000	42	25.0	M32 x 1.50	13.5 – 17.0	5.0	2	7111.25000
Hi-Q®/ERC 32	3432.20000	50	27.5	M40 x 1.50	14.5 – 18.0	5.0	2	7111.32000
Hi-Q®/ERC 40	3440.20000	63	30.5	M50 x 1.50	16.5 – 20.0	5.0	2	7111.40000
Hi-Q®/ERC 50	3450.20000	78	40.3	M64 x 2.00	19.0 – 26.0	5.0	2	7111.50000

See Page 50 for Sealing Disk (DS) & Page 56 for Coolant Flush Disk (KS)

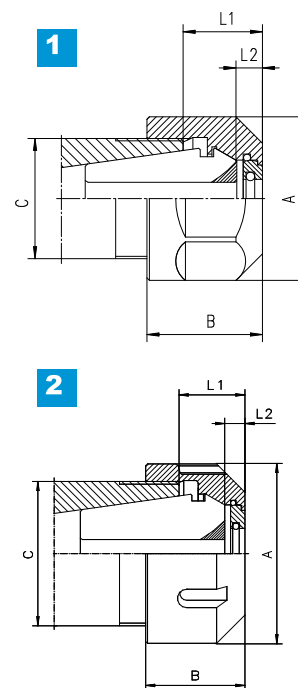

The maximum torque shall not be more than 25% above the recommended tightening torque.



Higher clamping force of the clamping nut at the same time means higher stress on the toolholder. We recommend the use of REGO-FIX® torque wrench. REGO-FIX® will not be responsible for damages to toolholders or spindles of other manufacturers.